

Stream Pumps

Trop-Stream 3000 - 5200 - 10800



Operation Instructions

Trop-Electronic GmbH - Kronprinzenstrasse 3a - 58511 Luedenscheid - Tel. 049-2351/4326800

www.troptronic.de

Trop-Stream Series Parts Diagram

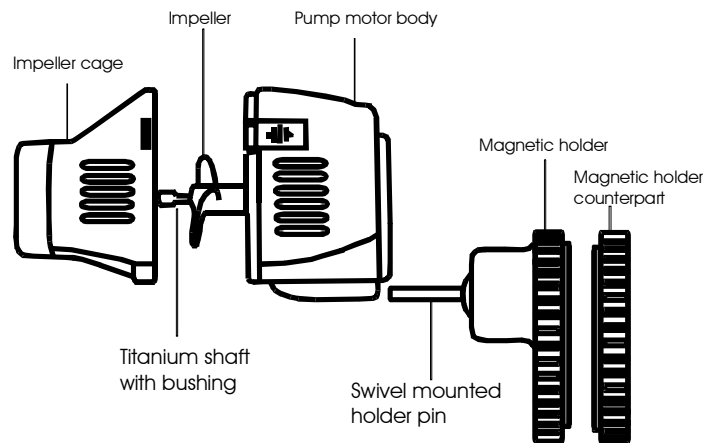

Installation:

1. Get the pump out of its cardboard box and check the pump for any signs of shipping damage. If damaged, do not operate the pump. Return the pump to the place of purchase.
2. Submerge the magnetic holder and adjust the desired flow direction by pushing the holder pin near the ball joint. Do not use force at the end of the holder pin and do not try to adjust when



the holder is dry. Both could easily damage the holder pin. Later you may do fine adjustment.

3. Get the pump holder out of the aquarium and plug the holder pin into the hole at the rear side of the pump.
4. Place the pump in the aquarium using the magnetic holders plates. Use a place where the pump could not cause damage in case it falls down. To avoid the pump of drawing air it should be approx. 10 cm under the surface. The pump is for operation under water only. Running dry voids the guarantee.
5. If necessary you may do some fine adjustment.
6. After the pump has the desired flow direction you should check that your hands and the pumps power plug are dry. Now connect the pump with the power net. The pumps power cable should have a "drip loop" to prevent water from running down ruining things below. For your own safety the outlet should be operated with a ground fault interrupter. Alternatively you may use our power strip with ground fault interrupter. Have a look at our website www.troponic.de.

Disassembly:

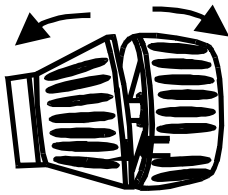

Step 1

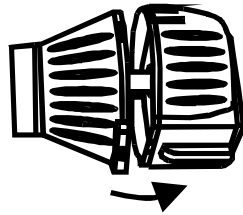

Step 2

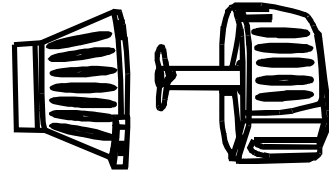

Step 3

Maintenance and cleaning

To maintain efficient performance of the pump, periodic cleaning is required.

1. Unplug the pump and remove it from the aquarium. Please be careful while disassembling, cleaning and reassembling the pump.
2. Clean the outside of the pumps motor body and impeller cage with a brush or scouring pad to remove accumulated algae and debris. The pumps streaming holes should be free. Do the cleaning under running water.
3. Remove the impeller cage by squeezing tabs on the pump motor body simultaneously. Tilt the impeller cage down to clear the tabs at the top. (Step 1 - 3).
4. Once clear at the tabs at the top, tilt the impeller cage the opposite direction to free the cage from the third tab located at the bottom of the pump.
5. Clean the impeller cage by wiping with a soft cloth. Rinse the pump motor body under fresh water.
6. Do not use aggressive cleaners or chemicals !
7. After cleaning reinsert impeller back into the impeller well and reattach cage.
8. Install pump back into the aquarium.

Data

	Consumption:	Flow rate*:	Recommended aquarium size:
Trop-Stream 3000	7 watts	3000/h	120-200 litres
Trop-Stream 5200	10 watts	5200/h	200-400 litres
Trop-Stream 10800	17 watts	10800/h	360-800 litres

* the flow rates have been checked in our lab